

D150 - 5KW 24VDC

**Câble jaune / Yellow wire /
Gelber Kabel**
Protection thermique
Thermal protection
Thermoschutzbegrenzer

Relais de démarrage
Starting relay
Einschaltrelais

Option :
Avec ventilation forcée
With forced ventilation
Mit Zwangslüftung

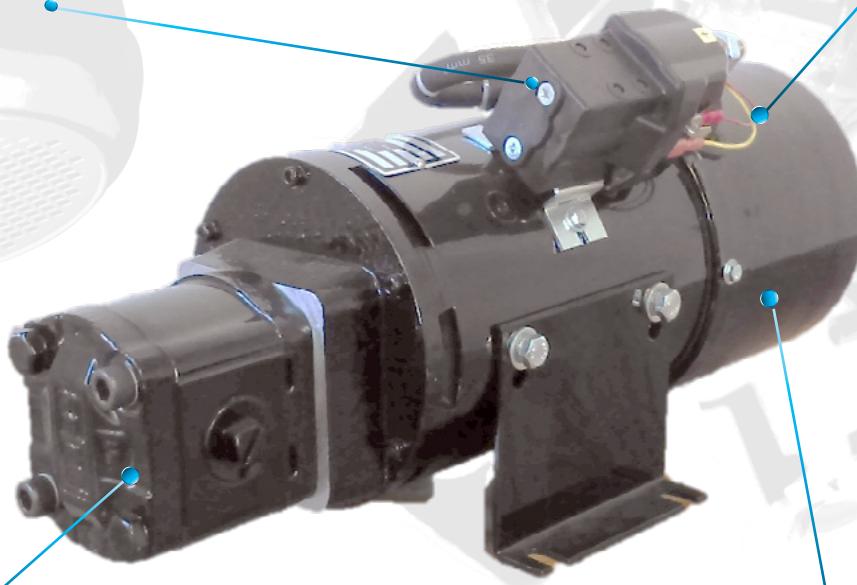

Pompe à engrenages série 2
Gear pump serie 2
Zahnradpumpe serie 2

Moteur D150 (ventilé)
Motor D150 (ventilated)
Motor D150 (Belüftet)

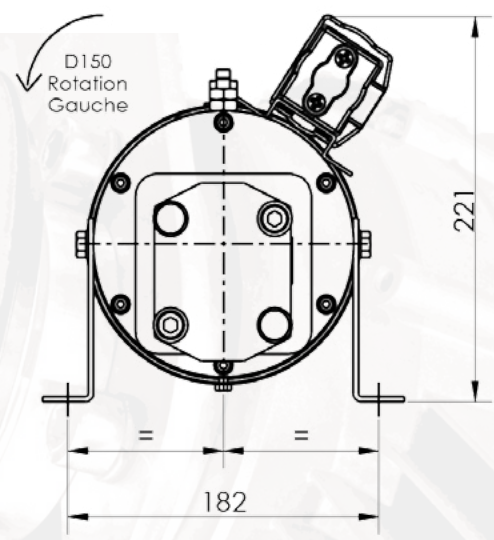
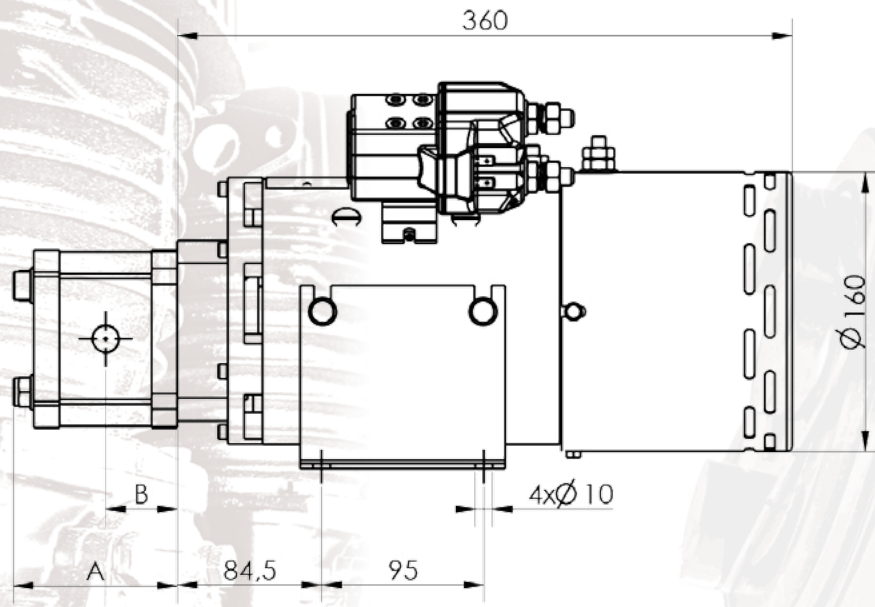

Cylindrée / Displacement / Hub	A	B	Ref. EMS CONCEPT
4 cm ³	86.1	39	12222034
6 cm ³	89.6	39	12223010
8 cm ³	92.9	41.1	12223016
10 cm ³	97.3	45.5	12224004

D150 - 5KW 24VDC

POMPE A ENGRENAGES SERIE 2

GEAR PUMP STAGE 2
ZAHNRADPUMPE SERIE 2

Cylindrée Disponible <i>Available volumetric displacement / Verfügbare volumetrische Verdrängung</i>	4 cm ³	6 cm ³	8 cm ³	10 cm ³
Pression Maximale <i>Maximum pressure / Maximalerdruck</i>	250 bar (3625 PSI)	250 bar (3625 PSI)	200 bar (2900 PSI)	180 bar (2610 PSI)
Raccordement pression <i>Pressure connection / Druck Anschluss</i>	3/8" BSP	3/8" BSP	3/8" BSP	3/8" BSP
Raccordement aspiration <i>Suction connection / Ausgang Anschluss</i>	3/8" BSP	1/2" BSP	1/2" BSP	1/2" BSP

MOTEUR AVEC BALAIS D150

D150 BRUSHED MOTOR
D150 KOHLENBÜRSTEN-MOTOR

Tension d'Alimentation <i>Voltage / Spannung</i>	24 VDC			
Puissance utile <i>Power / Leistung</i>	5000 W			
Vitesse Nominale (à pression max) <i>Nominal speed (at max pressure) Nennzahl (bei maximalem Druck)</i>	1950 RPM	1650 RPM	1450 RPM	1300 RPM
Intensité maximale <i>Maximum current consumption / Maximale Stromaufnahme</i>	232 A	313 A	320 A	330 A
Ventilé <i>Ventilated / Belüftet</i>	✓			
Excitation <i>Excitation / Erregung</i>	Series			
Isolation <i>Insulation / Isolierung</i>	F			
Protection Thermique <i>Thermal protection / Thermoschutzbegrenzer</i>	Sonde NF 100°C / NC 212°F Probe / NC 100°C Sensor			
Indice de protection <i>Protection Level / Schutzart</i>	IP 21			
Relais de démarrage <i>Starting relay / Einschaltrelais</i>	350 A			

ENSEMBLE

ASSEMBLY
GESAMTANLAGE

Position d'installation <i>Installation position / Einbaulage</i>	Horizontal
Températures de fonctionnement <i>Running temperatures / Betriebstemperatur</i>	-25°C -> +65°C / -13°F -> 149°F
Température minimale de stockage <i>Minimal storage temperature / Minimale Lagerungstemperatur</i>	- 40°C / - 40°F
Poids <i>Weight / Gewicht</i>	25 kg

FABRICATIONS SPECIALES SUR DEMANDE

SPECIAL ASSEMBLIES ON REQUEST / SONDERAUSFÜHRUNGEN AUF ANFRAGE



D150 - 5KW 24VDC

ESSAIS PERFORMANCES
PERFORMANCE TESTINGS
LEISTUNGSTESTS

POMPE 4CC / 4CC PUMP / 4CC PUMPE

PRESSION PRESSURE DRUCK P (Bar)	DEBIT FLOWRATE FÖRDERMENGE Q (L/Min)	VITESSE SPEED DREHZAHL n (Tr/Min)	TENSION POWER SPANNUNG U (V)	INTENSITE INTENSITY STROMAUFNAHME I (A)	PUISSANCE ABSORBEE POWER CONSUMPTION LEISTUNGS-AUFNAHME Pa (W)
15	17.6	4166	25	70	1750
20	16.4	3998	25	80	2000
30	15.5	3745	25	87	2175
40	14.5	3519	25	102	2350
50	13.8	3343	25	102	2550
60	13.2	3226	25	109	2725
70	12.5	3048	25	115	2875
80	12.3	2967	25	122	3050
90	11.8	2859	25	128	3200
100	11.4	2788	25	135	3375
110	11.1	2708	25	141	3525
120	10.9	2622	25	149	3725
130	10.5	2565	25	156	3900
140	10.4	2515	25	163	4075
150	10.0	2446	25	168	4200
160	9.6	2339	25	176	4400
170	9.4	2291	25	182	4550
180	9.3	2265	25	188	4700
190	9.0	2229	25	194	4850
200	8.8	2158	25	201	5025
210	8.06	2109	25	208	5200
220	8.3	2054	25	214	5350
230	8.0	2021	25	221	5525
240	7.9	1979	25	229	5725
250	7.8	1960	25	232	5800

COURBE DEBIT/PRESSION

Flow-pressure curve / Volumstrom-Druck Kurve

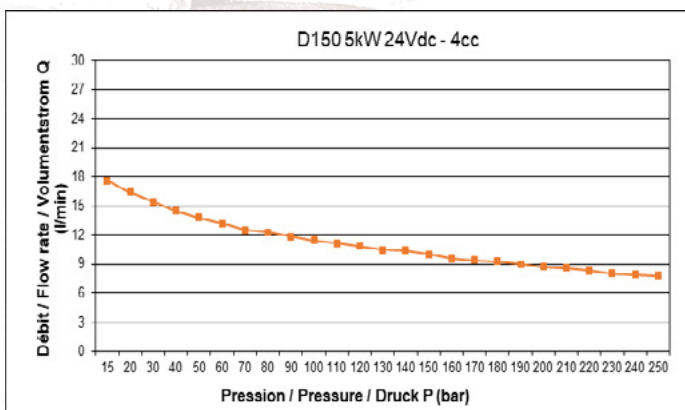

COURBE INTENSITE/PRESSION

Intensity-pressure curve / Intensität-Druck Kurve

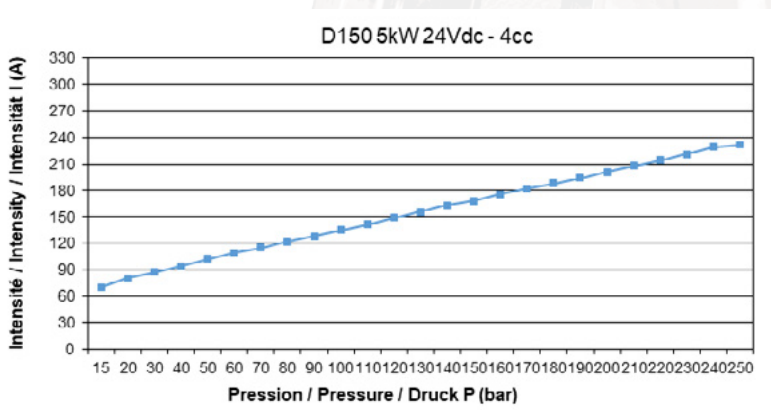

D150 - 5KW 24VDC

ESSAIS PERFORMANCES
PERFORMANCE TESTINGS
LEISTUNGSTESTS

POMPE 6CC / 6CC PUMP / 6CC PUMPE

PRESSION PRESSURE DRUCK P (Bar)	DEBIT FLOWRATE FÖRDERMENGE Q (L/Min)	VITESSE SPEED DREHZAHL n (Tr/Min)	TENSION POWER SPANNUNG U (V)	INTENSITE INTENSITY STROMAUFNAHME I (A)	PUISSANCE ABSORBEE POWER CONSUMPTION LEISTUNGS-AUFNAHME Pa (W)
5	22,7	4450	26	66	1716
25	21,6	3725	26	88	2288
30	20,9	3609	26	94	2458
40	19,4	3385	26	104	2728
50	18,2	3180	26	114	3015
60	17,0	3025	26	126	3242
70	16,2	2901	25	137	3451
80	15,7	2818	26	148	3776
90	15,0	2720	26	158	4116
100	14,4	2620	26	168	4373
110	13,8	2525	25	178	4449
120	13,2	2435	25	189	4654
130	12,9	2383	25	198	4950
140	12,4	2315	25	208	5200
150	11,6	2198	25	218	5450
160	11,5	2180	25	228	5695
170	11,0	2102	25	239	5968
180	10,5	2040	25	248	6190
190	10,0	1976	24	258	6182
200	9,7	1950	24	265	6370
210	9,4	1896	24	276	6624
220	9,0	1845	24	285	6840
230	8,6	1787	24	293	7032
240	8,0	1725	24	305	7320
250	7,5	1662	24	313	7512

COURBE DEBIT/PRESSION

Flow-pressure curve / Volumstrom-Druck Kurve

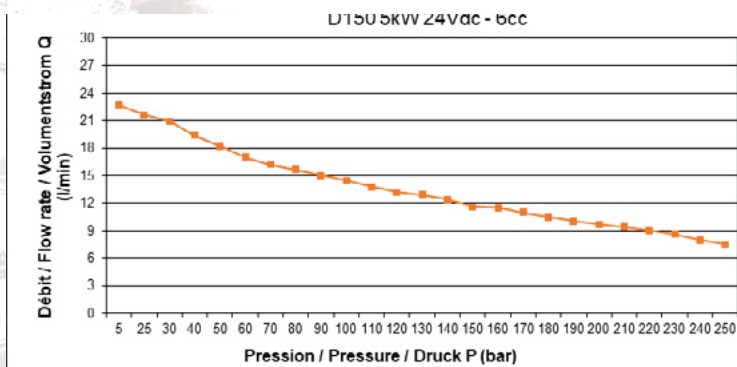

COURBE INTENSITE/PRESSION

Intensity-pressure curve / Intensität-Druck Kurve

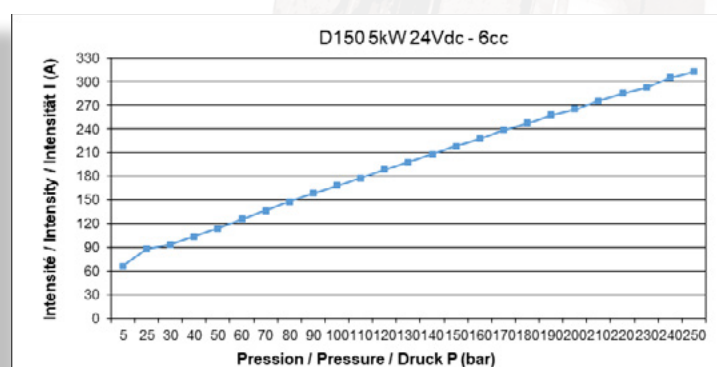

D150 - 5KW 24VDC

ESSAIS PERFORMANCES
PERFORMANCE TESTINGS
LEISTUNGSTESTS

POMPE 8CC / 8CC PUMP / 8CC PUMPE

PRESSION <i>PRESSURE</i> <i>DRUCK</i> P (Bar)	DEBIT <i>FLOWRATE</i> <i>FÖRDERMENGE</i> Q (L/Min)	VITESSE <i>SPEED</i> <i>DREHZAHL</i> n (Tr/Min)	TENSION <i>POWER</i> <i>SPANNUNG</i> U (V)	INTENSITE <i>INTENSITY</i> <i>STROMAUFNAHME</i> I (A)	PUISSANCE ABSORBEE <i>POWER CONSUMPTION</i> <i>LEISTUNGS-AUFNAHME</i> Pa (W)
20	27,5	3517	27	88	2370
30	24,7	3275	27	103	2776
40	23,3	3019	27	117	3126
50	20,3	2813	26	129	3412
60	18,4	2604	26	144	3799
70	17,4	2496	26	156	4056
80	16,1	2385	26	169	4375
90	15,8	2262	26	183	4694
100	14,8	2164	25	196	4925
110	13,9	2096	25	209	5166
120	13,5	1970	25	221	5479
130	12,6	1900	25	234	5775
140	11,9	1822	24	246	5914
150	10,6	1757	24	260	6261
160	10,3	1689	24	271	6382
170	9,3	1629	24	286	6833
180	9,0	1557	23	296	6846
190	9,0	1485	24	309	7289
200	8,4	1428	23	320	7466

COURBE DEBIT/PRESSION

Flow-pressure curve / Volumenström-Druck Kurve

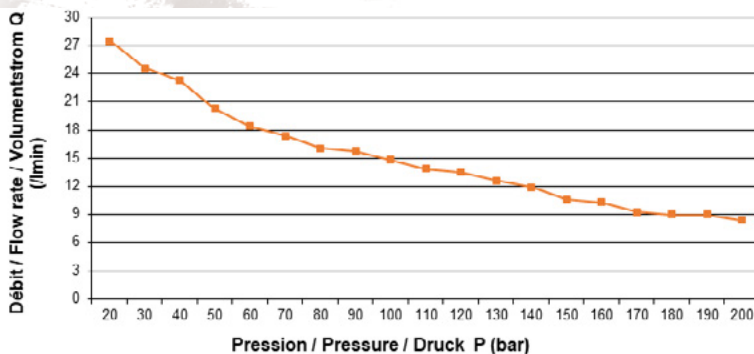

COURBE INTENSITE/PRESSION

Intensity-pressure curve / Intensität-Druck Kurve

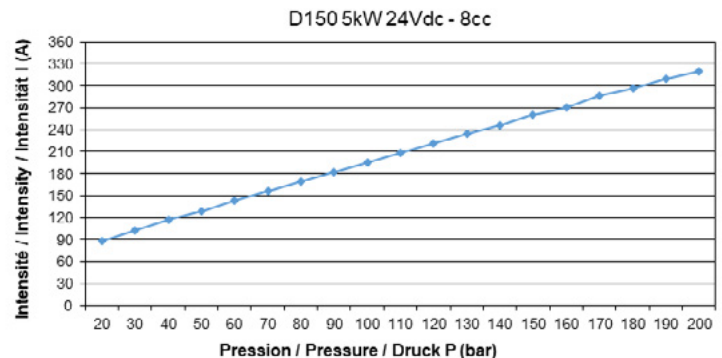

D150 - 5KW 24VDC

ESSAIS PERFORMANCES PERFORMANCE TESTINGS LEISTUNGSTESTS

POMPE 10CC / 10CC PUMP / 10CC PUMPE

PRESSION <i>PRESSURE</i> <i>DRUCK</i> P (Bar)	DEBIT <i>FLOWRATE</i> <i>FÖRDERMENGE</i> Q (L/Min)	VITESSE <i>SPEED</i> <i>DREHZAHL</i> n (Tr/Min)	TENSION <i>POWER</i> <i>SPANNUNG</i> U (V)	INTENSITE <i>INTENSITY</i> <i>STROMAUFNAHME</i> I (A)	PUISSANCE ABSORBEE <i>POWER CONSUMPTION</i> <i>LEISTUNGS-AUFNAHME</i> Pa (W)
50	24.7	2350	23	144	3254.4
80	21.0	2000	23	186	4203.6
100	19.0	1800	23	216	4881.6
120	17.8	1700	23	246	5559.6
150	15.7	1500	23	288	6508.8
180	13.8	1300	23	330	7458.0

COURBE DEBIT/PRESSION

Flow-pressure curve / Volumenström-Druck Kurve

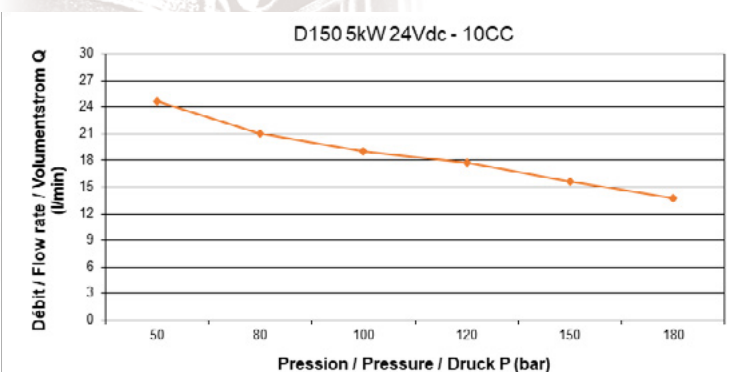

COURBE INTENSITE/PRESSION

Intensity-pressure curve / Intensität-Druck Kurve

